

O-RING KIT FOR MANITOU SWINGER & METEL COIL SHOCKS 2004-2005

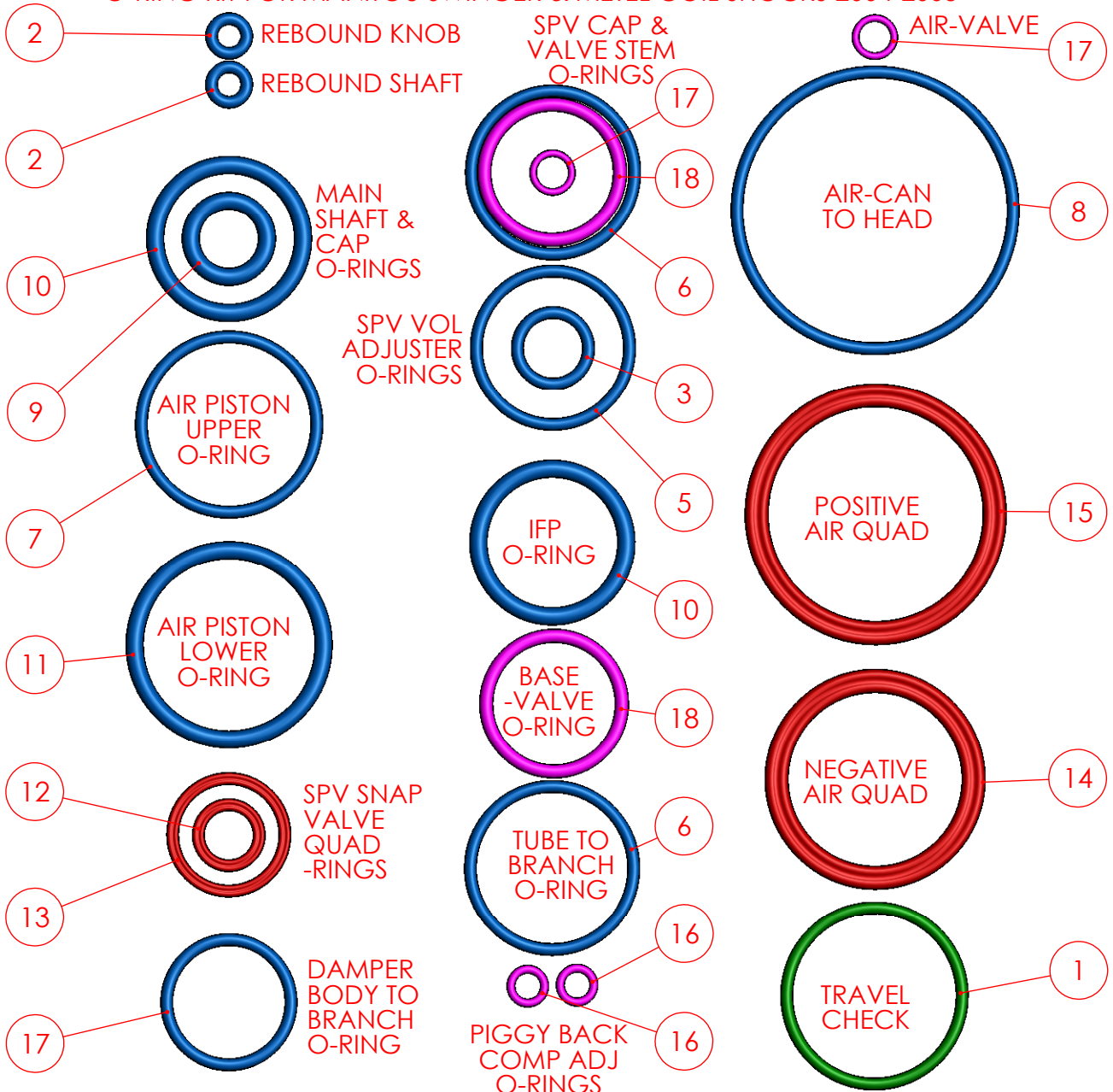

THIS DOCUMENT IS COPYRIGHT © SIGNAL HOLDINGS LTD. SHOCKCRAFT & ENGEN ARE REGISTERED TRADEMARKS OF SIGNAL HOLDINGS LTD

SERVICE INFO FOR MANITOU SWINGER 4/6 WAY AIR SHOCKS 2004-2007

Oil Specification: Motorex 2.5wt (15 cSt)
 IFP Depth: See Table
 IFP Fill: Schrader Valve (SWINGER), IFP Keychain tool (METEL)
 IFP-SPV Pressure: 50-175psi - This pressure sets compression damping

IDENTIFICATION:

SWINGER SHOCKS HAVE RED SPV AIR PRESSURE VALVE TO SET COMPRESSION
 METEL SHOCKS HAVE A SMALL 5 POINT SCREW CAP INSTEAD

SWINGER 3 WAY IS AN INLINE SHOCK WITH SPV DAMPER

- ADJUSTABLE REBOUND, PRELOAD AND SPV PRESSURE (3 WAY ADJUSTABLE)

SWINGER 4 WAY IS A PIGGY BACK SHOCK WITH SPV DAMPER

- ADJUSTABLE REBOUND, PRELOAD, SPV VOLUME AND PRESSURE (4 WAY ADJUSTABLE)

SWINGER 6 WAY IS A PIGGY BACK SHOCK WITH SPV DAMPER & COMP ADJUSTERS

- ADJUSTABLE REBOUND, PRELOAD, LOW SPEED COMPRESSION, HIGH SPEED COMPRESSION, SPV VOLUME AND PRESSURE (6 WAY ADJUSTABLE)

2004-2007 MODELS HAVE GOLD ANODISED AIR-CANS

2008-2015 MODELS HAVE BLACK ANODISED AIR-CANS

4 WAY HAS ROUND BLANK CAP, 6 WAY HAS CONCENTRIC COMP ADJUSTERS

IFP DEPTH ON INLINE SHOCKS
 (SWINGER 3 WAY AND METEL R)
 SET BY BOTTOMING SHAFT TO THREADS
 WITH NO BUMPER ON THE SHAFT

IFP Depth TO PISTON OUTER LIP	SWINGER 4-6 WAY AIR	2004-2007 TOOLED VOLUME
Stroke Metric	Stroke Imperial	IFP Depth (mm)
38	1.5 inch	35
51	2 inch	38.5
57	2.25 inch	40
63	2.5 inch	41.5
70	2.75 inch	43
76	3 inch	44.5

BEST MANUAL BLEED IS BY THE
 SHAFT HOLE WHEN HEAD AND
 REBOUND NEEDLE REMOVED

TOOLS & SPARES:

EYELET BUSHINGS - Shockcraft 12mm DU bushing

IFP KEYCHAIN TOOL - IFP Valve Tool Keychain (Manitou) HB-83-2694

Needed for METEL shocks for the 5 point cap and IFP recharge